



SANTONI™

ATLAS

ULTRA FINE SINGLE JERSEY MACHINE WITHOUT SINKERS

超细针距无沉降片的单面针织圆机

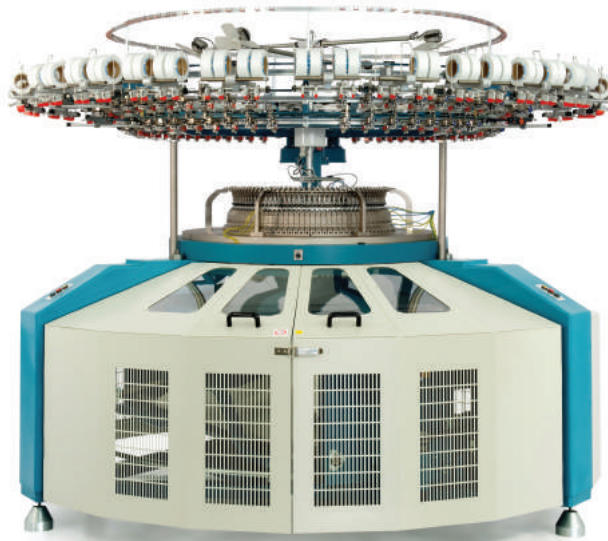

Superior fabric quality
完美的布面质量

Sinker less technology
无沉降片技术

Higher productivity
更高的生产效率

ATLAS 简介



- 机器配置2跑道结构。
- 圣东尼专利握持片确保线圈脱套后，快速重新起头。
- 由于没有沉降片，无需沉降片与织针配合变化。
- 无沉降片技术的优点（无沉降片和沉降片罩）：
 - 没有导纱器位置变化产生的LYCRA漏针。
 - 较小的纱线（以及LYCRA）弯纱变形，在均匀成圈产生较小的纱线张力或损耗。
 - 可以得到比使用沉降片的圆机更少10%-15%的线圈长度。
 - 织物拉伸后，比使用沉降片的圆机具有更高的恢复比率。
 - 无沉降片产生的针路。
 - 大约减少15%能耗。
 - 由于编织部件的摩擦力减小，而使速度可以更高。
 - 更长的织针寿命。
- 导纱嘴位于起来工作的织针前，即使在高速状态下，亦可完美垫纱。
- 独立三角座由特殊铝合金（Ergal）制成，具有超强散热功能。
- 牵拉装置的自动定位使落布卷更加快捷。
- 可以在圆筒机架或开幅机架（标准款和大卷装款）安装马达控制剪裁开幅刀和斜向导布辊（Vignoni专利）。
- 非常紧凑的开幅机架，便于进入编织区域。
- ATLAS可以达到世界上最细的90机号。

ATLAS BRIEF



- Machine can produce up to 2 cam track structures.
- Holding-down jacks(Santoni Patent) ensures quick re-start of fabric after press-off.
- No change in sinker timing required due to the absence of sinkers.
- Advantage of sinker less technology (absence of sinkers and sinker cap):
 - Zero lycra miss plating due to no major change in yarn guide position.
 - Uniform loop formation as there are lesser deflection points for yarn(&lycra),results in lesser tension or abrasion on yarns while loop formation.
 - Possibility to achieve 10% to 15% tighter loop lengths than possible on any machine with sinkers.
 - Recovery after stretch,percentage much higher compared to fabrics knitted on machines with sinkers.
 - No sinker lines.
 - Lesser power consumption by about 15%.
 - Higher speed thanks to reduced friction of knitting elements.
 - Longer needles life.
- Yarn carrier in front of the raised needles for a perfect plating at high speed.
- Individual cam shells made by special aluminum alloy (Ergal) having a great heat dissipation property.
- Automatic positioning of the fabric take-down for quick removal of fabric roll.
- Available with tubular as well as Open width frame (standard and industrial)equipped with motorized slitting and opening system by oblique bars(Vignoni patent).
- Very compact open frame for an easy access to the knitting head.
- ATLAS is available up to 90 gauge,the finest gauge ever built in the world!

ATLAS



SANTONI™

筒径	26	30	32	34	36	Diameter	26	30	32	34	36
针距	40 - 90					Gauge	40 - 90				
路数	76	88	94	100	106	Number of feeds	76	88	94	100	106
最高转速 (E40)	34	30	28	26	24	Maximum Speed (Reference: E40)	34	30	28	26	24

		布卷/毫米	机架尺寸/毫米			Fabric roll/MM	Fabric size/MM
机架	标准圆筒机架	500		Frame	Tubular standard	500	
	大卷装圆筒机架	780	+ 500		Tubular industrial	780	+ 500
	大卷装圆筒机架	1080	+ 800		Tubular industrial	1080	+ 800
	标准开幅机架	380			Open width standard	380	
	大卷装开幅机架	600	+ 300		Open width industrial	600	+ 300

标准配置	<ul style="list-style-type: none"> - 侧纱架 - 积极送纱装置 - 独立的三角座, 可安装4跑道三角 - 上翻式黑锆陶瓷导纱嘴用于2根和3根添纱织物 - 细微线长调节 - 自动加油系统 - 电动马达驱动 (变频器) - LFA线长测量装置 - 电子探针器 - 马达控制剪裁开幅刀和斜向导布辊 (开幅机架) 	Standard Equipment	<ul style="list-style-type: none"> - Aluminum side creel - Positive feeding units - Individual cam shells prepared to receive up to 4 cam tracks - Flip-up Zirconium yarn carrier for two and three yarn plating - Micrometrical stitch adjustment - Automatic oiling system - Electronic motor drive(inverter) - LFA-Yarn input measuring device - Eletronic needles detector - Motorized slitting and fabric opening system (Open width)
------	--	--------------------	--

选配件	<ul style="list-style-type: none"> - 裸氨纶送纱器 - 开幅机架 (26" - 32", 220厘米; 34"以上, 245厘米) - 摆布装置 (圆筒机架) - 大卷装机架 (圆筒和开幅) - 单珠地 - 假棉毛三角 (高达62机号) 	Optional	<ul style="list-style-type: none"> - Lycra feeding units - Open width frame (26" - 32", 220cm - above 34", 245 cm) - Lapping device system(tubular frame) - Industrial frame(both tubular and open width) - Cams for pique' - Mock Interlock (up to E62)
-----	--	----------	--

产品应用	内衣, 运动衣, 泳衣, 工艺用布	Application area	Underwear, Sportswear, Swimwear, Technical Textiles
------	-------------------	------------------	---

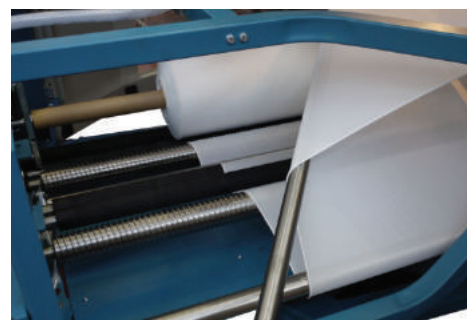
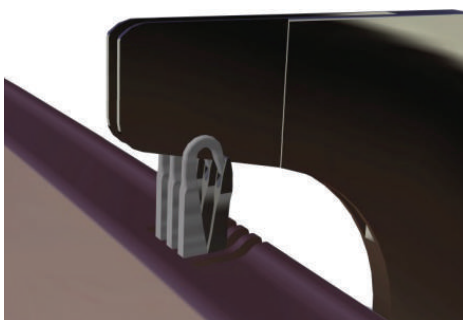
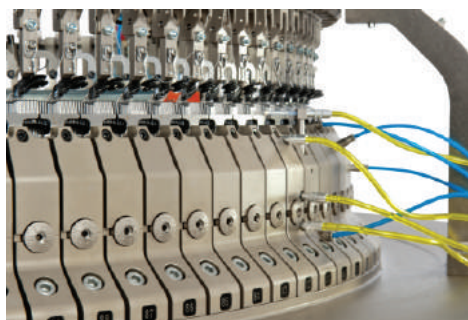

Disclaimer: All features in the brochure are for information only and subject to change without any prior notice. For a complete list of configuration, please contact Santoni Shanghai sales network.

声明: 宣传单中的所有信息仅作参考, 圣东尼公司有权先行修改。请联系圣东尼 (上海) 销售部查询完整配件清单。

2017 V02

SANTONI (SHANGHAI) KNITTING MACHINERY CO.,LTD

Add: No.111, East Shanfu Road, Jinshan, Shanghai 201508, China

Tel: +8621-57240777 Fax: +8621- 3721 2624 Website: www.santoni.cn

圣东尼 (上海) 针织机器有限公司

地址: 上海市金山区山富东路111号 邮编: 201508

总机: +8621-57240777 传真: +8621-3721 2624 网站: www.santoni.cn